

Existing Conditions

Approximate Length of loading area is 50 feet.

Exploded View  
Scale: 1"=1'

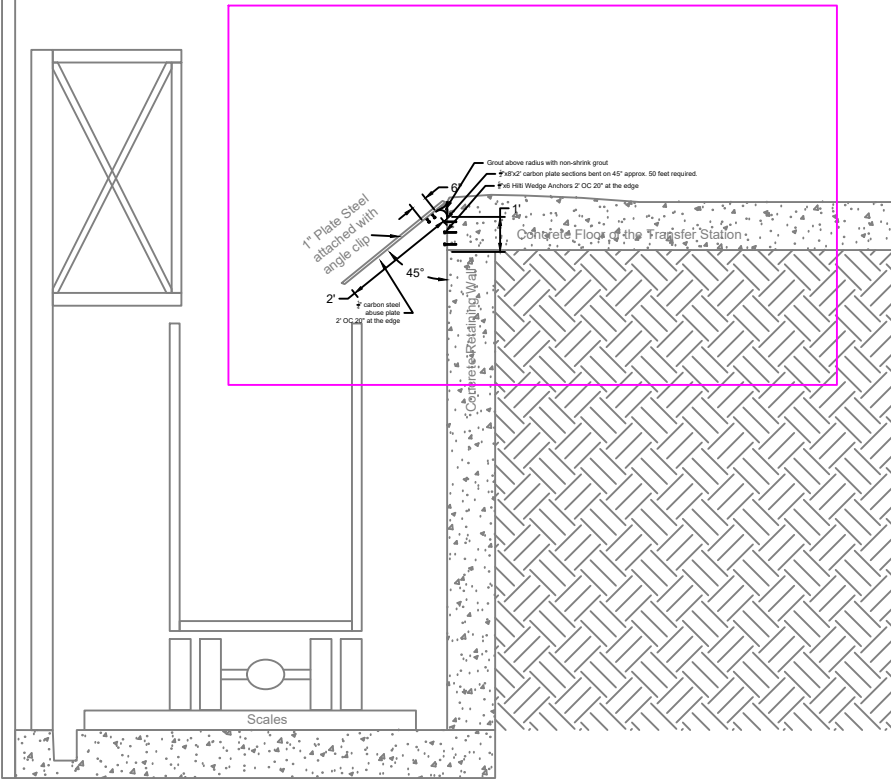

CROSS SECTION  
Scale: 1"=4'

Scope:

1. Site visit is required to bid the project (by appointment only). Contact Tim Frye 276-620-8946.
2. Contractor to submit shop drawings and Schedule to Tim Frye for Approval before starting.
3. Operations at the transfer Station cannot be shut down with this project.
4. Coordinate with Tim Frye, the manager of the transfer station.
5. Fabricate Plate.
6. Remove all existing steel along the 50 feet edge of the loading dock.
7. Anchor fabricated Plate to Concrete.
8. Bolt  $\frac{1}{4}$ " abuse plate onto  $\frac{1}{2}$ " plate.

Scale: 1"=1'

Legend  
Proposed \_\_\_\_\_

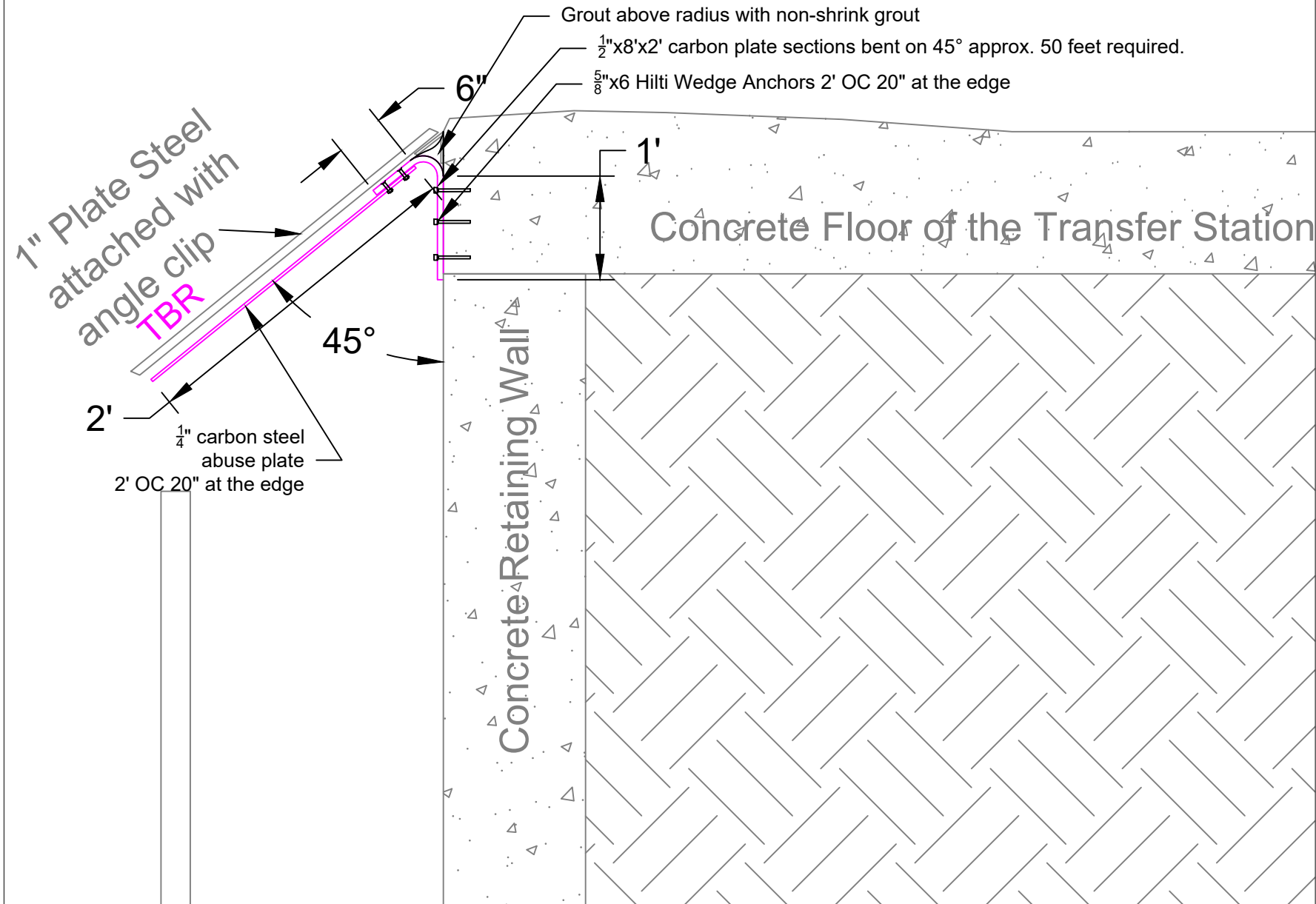

Exploded View  
Scale: 1"=1'



Proposed Work at JPSA  
Transfer Station

Date 6-13-21

As Shown

No.	Revision	Date

Sheet

1 of 1